



## OWNER'S MANUAL

- Contains:**
- Safety Information
  - Warranty Information
  - Operating Instructions
  - How to Unload
  - Cleaning and Lubrication
  - Annotated Diagram
  - Trouble Shooting Guide

**WARNING:** This safety alert symbol indicates important safety messages in this manual. When you see this symbol, be alert to the possibility of personal injury and carefully read the message that follows.

**WARNING:** THIS IS NOT A TOY. MISUSE MAY CAUSE SERIOUS INJURY OR DEATH. EYE PROTECTION DESIGNED FOR PAINTBALL USE MUST BE WORN BY THE USER AND ANY PERSON WITHIN RANGE. RECOMMEND AT LEAST 18 YEARS OLD TO PURCHASE, 14 YEARS OLD TO USE WITH ADULT SUPERVISION, OR 10 YEARS OLD TO USE ON PAINTBALL FIELDS MEETING ASTM-STANDARD F1777-02. READ OPERATION MANUAL BEFORE USING.

**WARNING:** NEVER SHOOT AT ANYONE WITHOUT PROPER PROTECTIVE EQUIPMENT FOR EYES, EARS, THROAT AND HEAD, WHICH MUST BE WORN AT ALL TIMES. EYE PROTECTION MUST BE DESIGNED SPECIFICALLY FOR PAINTBALL USE. FAILURE TO FOLLOW THESE SAFETY PRECAUTIONS MAY RESULT IN BODILY INJURY INCLUDING BLINDNESS AND DEAFNESS.



Welcome to the Brass Eagle® team and thank you for purchasing this high quality Brass Eagle® paintball marker.

We at Brass Eagle® stand committed to providing you with the best product and service available. Your new marker is designed and manufactured to provide ease of maintenance with trouble free performance. We ask that you read this manual to obtain the maximum enjoyment of your purchase.

Call 1-877-877-GAME (4263) or visit our web site if you should need an illustrated parts list.



**brass eagle®**

Brass Eagle, LLC  
P.O. Box 1956, Rogers, AR 72757, U.S.A.  
877-877-GAME(4263) Fax: (479)464-8701  
www.brasseagle.com

## RULES OF SAFE PAINTBALL MARKER HANDLING

1. Always wear proper eye, face and ear protection designed especially to stop paintballs.
2. Never shoot a person who is not wearing proper protection.
3. Treat every paintball marker as if it were loaded.
4. Never look down the barrel of the marker.
5. Never point the paintball marker at anything you don't wish to shoot.
6. Keep the paintball marker on safe until ready to shoot.
7. Keep the barrel plug in the paintball marker's muzzle when not shooting.
8. Always remove gas source before disassembly.
9. Store the paintball marker unloaded and degassed in a locked place.
10. Follow warnings listed on gas source for handling and storage.
11. Never use anything other than .68 caliber paintballs.
12. Do not shoot fragile objects such as windows.
13. Paintballs may cause staining of some porous surfaces such as brick, stucco and wood.
14. Always measure velocity before playing paintball.
15. Never shoot at velocities in excess of 300 feet per second.
16. Never engage in vandalism.
17. Do not use marker for drive-by shooting.
18. Do not modify your marker's pressurized air system or cylinder in anyway.

Use a chronograph to insure the marker's velocity is set accurately.

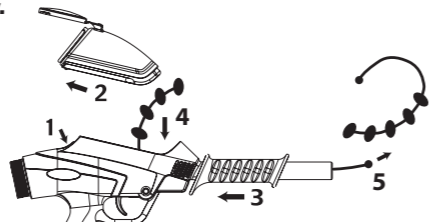

Use a barrel squeegee to clean broken paintballs from your marker's barrel. We recommend the Viewloader® Proflex™ paintball Squeegee #5012 for easy cleaning.

## WARRANTY INFORMATION

### WARRANTY: LIMITED 90 DAY WARRANTY (ORIGINAL PURCHASE RECEIPT REQUIRED)

For 90 days from date of purchase, Brass Eagle® will repair or replace this marker free of charge if defective in material or workmanship. This warranty gives you specific legal rights. You may also have other rights which may vary from state to state. Service is available from authorized Brass Eagle® Service Centers. A list of these is available at Brass Eagle's website—www.brasseagle.com or by calling Brass Eagle® at 1-877-877-GAME (4263). These Service Centers generally offer the quickest service.

**If you would rather return your marker to Brass Eagle® please call consumer service at 1-877-877-GAME (4263) for return authorization number and shipping address. (Authorization number must be visible on outside of shipping package to be accepted.)**

Do Not return any products via non-trackable services such as regular mail or parcel post. Such products may be lost and Brass Eagle® Inc. will not be responsible for replacement.

### PAINTBALL MARKERS OUT OF WARRANTY

Authorized Service Centers will gladly repair any markers out of warranty for a nominal charge to cover parts and labor. Repairs made by Service Centers will usually be faster and less expensive than those sent back to the factory. Go to [www.brasseagle.com/service](http://www.brasseagle.com/service) for service center locations near you. **Prior to shipping out of warranty markers, you should first call consumer service at 1-877-877-GAME (4263) for return authorization number and shipping address. (Authorization number must be visible on outside of shipping package to be accepted.)** Any out of warranty Saber™ Twin Turbo returned to Brass Eagle® must be shipped prepaid and include the repair fee. Please call the Customer Service number for current repair fees. Brass Eagle® will repair or replace the marker with a reconditioned unit of the same model. If payment is not included, you will be billed for the repair fee plus a \$4.00 invoicing fee. Upon receipt of payment, the marker or its replacement will be shipped to you. In the event that the marker includes no means of contacting the sender or no payment for repairs is received within 60 days of billing, the ownership of the marker will be forfeited and it will be disposed of at the discretion of Brass Eagle® Inc.

### CLEANING AND LUBRICATING

Cleaning and oiling marker prevents 90% of marker problems

**Step 1.** Thoroughly clean barrel and breach area. (Fig B) Recommends Viewloader® Proflex paintball Squeegee #5012 for easy cleaning.

**Step 2.** Remove any paintball residue and gelatin fragments (paintball shells). Use rubbing alcohol or diaper wipes if greater cleaning is desired (Fig C). Lubricate immediately after cleaning.

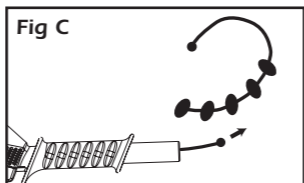
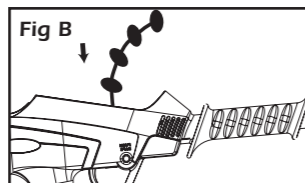

## TROUBLE SHOOTING GUIDE

PROBLEM	CAUSE	CURE
Marker Fails to Discharge	Marker is not Cocked	Cock Marker Pump Handle
	Lack of Gas Pressure	Install New 12gm CO2 Cylinders
	Gas Source Not Fully Engaged	Tighten Piercing Screw
	Operating Temperature Too Cold	Operate in Warmer Temperature
	Broken Paintball	Squeegee Out Paintball Fragments in Barrel

## OPERATING INSTRUCTIONS

**WARNING:** Be sure the paintball marker is always pointed in a safe direction. Read the following operating instructions and WITHOUT LOADING ANY PAINTBALLS proceed several times through the operating steps with your paintball marker (dry fire the paintball marker at a safe target) so that you will be able to operate the marker properly and safely.

**Step 1. PUT ON 'SAFE'.** Push safety from left to right; (Fig D) (no red band showing). Make sure barrel plug is placed securely in muzzle of marker. (Fig E)

**Step 2. ATTACH POWER SOURCE** Marker can be used with Brass Eagle® 12 gram CO2 cylinders. Use piercing screw to install the CO2 cylinder (Fig F). Turn screw clockwise to tighten until cartridge has been pierced. **DO NOT OVER TIGHTEN.**

**WARNING:** Use only CO2 cylinders which are 12 gram type. (Recommend Eagle Air™ 12 gram CO2 cylinders Item #7105, #7115 or #7125) Any attempt to use other sizes and/or cylinders containing other types of gas could be extremely dangerous. The use of gasses other than CO2 could result in an explosion or rupture of the marker, causing serious injury.

**WARNING:** CO2 cylinders may explode at temperatures above 130°F (54.4°C). (Fig G)

**Step 3. LOAD PAINTBALLS:** 1) Press Loader (Included) into ball feed port. (Fig H)

2) Pour paintballs into loader. (Fig I) **NOTE:** Paintballs are gravity fed from loader to the marker each time the marker is cocked. Too rapid a rate of fire, broken balls or too many balls in loader may cause subsequent balls to break and will adversely affect the paintball marker's accuracy. Use a squeegee to clean inside the paintball marker's barrel. (RECOMMEND Brass Eagle®, ViewLoader® or JT® brand .68 caliber paintballs.)

Paintballs should be stored in a cool, dry place in sealed plastic bags. Do not subject to freezing, excessive heat, humidity or store in direct sunlight. These conditions may cause ball breakage and/or poor feeding.

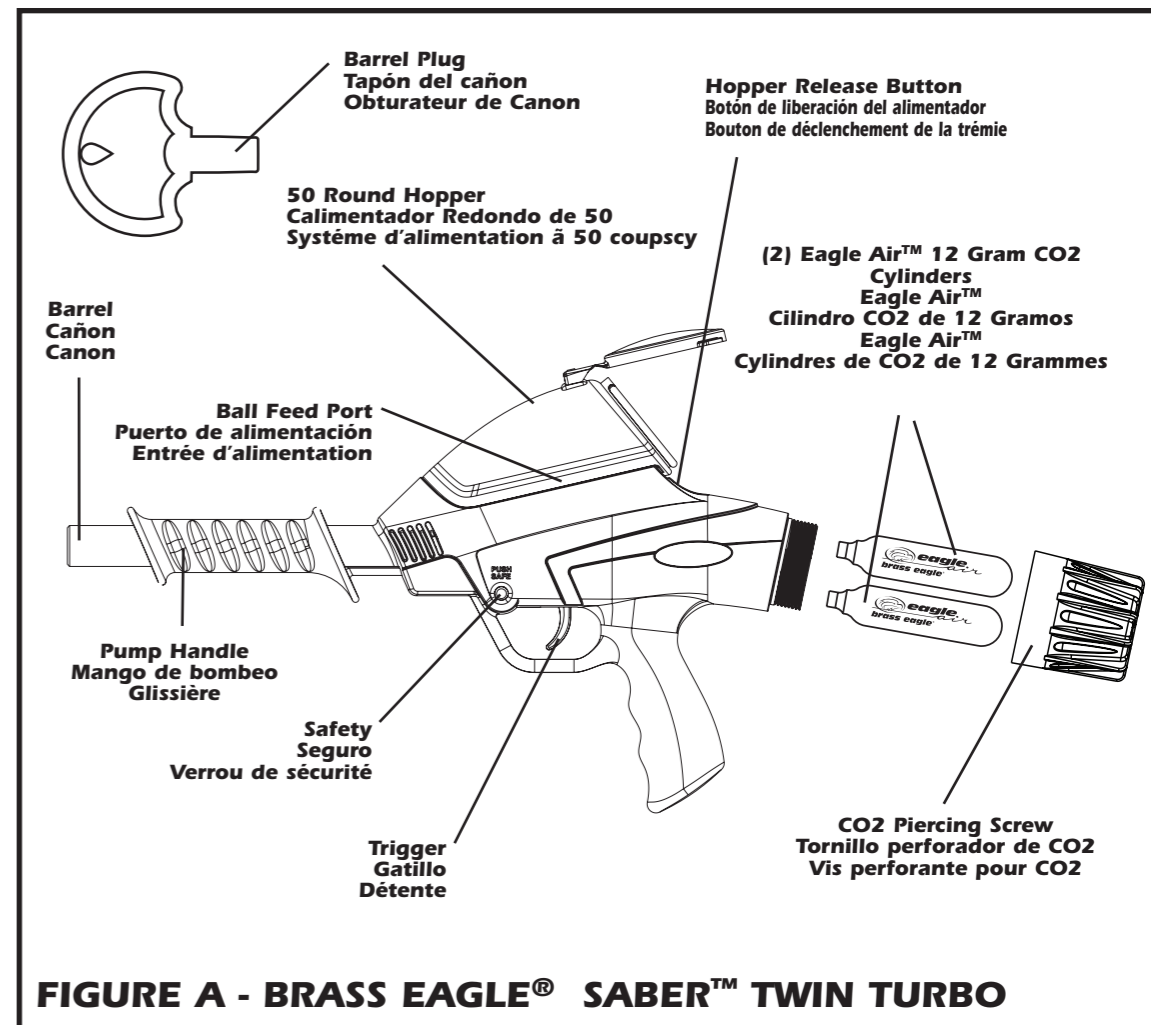

FIGURE A - BRASS EAGLE® SABER™ TWIN TURBO

**Step 4. EYE PROTECTION:** Make sure everyone within range (200 yards) is properly protected from paintball impacts. (Fig J)

**Step 5.** Remove barrel plug (Fig K) and take off safe by pressing safety from right side of marker until red band is showing. (Fig L)

**Step 6. COCK:** Cock marker by pulling pump arm fully back until you hear "click" (sound of sear engaging) (Fig M). Push pump arm fully forward until "click" is heard again (Fig N).

Now anti-double feed feature is engaged and a second ball cannot be fed into chamber. The Saber™ Twin Turbo is a pump actuated marker, which needs to be pumped after firing to chamber the next paintball and to compress the hammer spring. The marker may not cock (sear may not engage) when the 12 gram CO2 is low on pressure or when there are no 12 gram CO2 cylinders installed.

**STEP 7. VERIFY VELOCITY:** Verify that the paintball marker's velocity is below 300 feet per second or less if required by playing field (ASTM standard F1777-02). Velocity should be measured with a chronograph prior to playing paintball

**Step 8. FIRE.** Marker is now ready to fire (Fig O).

**WARNING:** Never shoot at anyone without proper protective equipment for eyes, which must be worn at all times. Eye protection must be designed specifically for paintball use. Failure to follow these safety precautions may result in bodily injury including blindness and deafness.

## UNLOADING YOUR MARKER

**WARNING:** Always wear proper eye, face and ear protection designed especially to stop paintballs while un-loading your Saber™ Twin Turbo paintball marker (Fig P).

**STEP 1.** Make sure barrel plug is securely in muzzle of marker (Fig Q).

**STEP 2.** Put Marker on safe. Push safety from left to right, no red showing (Fig R).

**STEP 3.** Remove the CO2 cylinder by unscrewing the piercing screw (Fig S).

**STEP 4.** Remove loader (Fig T).

**STEP 5.** Turn marker upside down to remove paintballs from feed port (Fig U).

**STEP 6.** Insert squeegee into barrel to insure paintballs are removed or dislodged through feed port (Fig U).

Do not unload your marker indoors.

**WARNING:** Never look down the barrel of the marker.

